

PrimaVision Mini for CDM

HID-PV m 20 /I CDM HPF 220-240V 50/60Hz

Miniature HID electronic gear for PGJ5 CDM lamps – freeing up the boundaries of creativity and innovation in luminaire design

Product data

• General Information

Application Code	HPF
Type Version	MK1
Lamp Type	CDM
Number Of Lamps	1 piece/unit
Suitable For Outdoor Use	No
Number Of Products On MCB (16A Type B) (Nom)	24

• Operating and Electrical

Input Voltage	220 to 240 V
Input Frequency	50 to 60 Hz
Minimum Mains Voltage Operation (Min)	198 V
Power Factor 100% Load (Nom)	0.95
Ignition Voltage (Max)	4.5 kV
Ignition Voltage (Min)	3.3 kV
Ignition Switch-Off Time (Nom)	21 min
Mains Voltage Performance (AC)	198-254V
Mains Voltage Safety (AC)	180-264V
Earth Leakage Current (Max)	0.5 mA
Inrush Current Width	0.25 ms
Constant Wattage Deviation	-3%/+3%
Power Losses (Nom)	4.5 W

Inrush Current Peak (Max) 15 A

• Wiring

Cable Capacity	150 pF
Output Wires Mutual (Nom)	
Cable Length From Device To Lamp	2 m
Wire Striplength	10.0-11.0 mm
Ballast Contact Wire Cross Section	0.75-2.50 mm ²
Connector Type	Insert

• System characteristics

Rated Ballast-Lamp Power 20 W

• Temperature

T-Ambient (Max)	45 °C
T-Ambient (Min)	-20 °C
T-Storage (Max)	80 °C
T-Storage (Min)	-25 °C
T-Case Lifetime (Nom)	75 °C
T-Case Maximum (Max)	75 °C

• Mechanical and Housing

Housing INDEPENDENT

PHILIPS

PrimaVision Mini for CDM

• Approval and Application

Active Temperature Protection	Yes
EMI 9 kHz ... 300 MHz	CISPR 15 ed 7.2
Vibration Standard	IEC68-2-6FC
Bumps Standard	IEC 68-2-29 Eb
Approval Marks	F-Marking CE marking ENEC certificate CB Certificate
Hum And Noise Level	Inaudible

• Product Data

Full product code	872790089060000
Order product name	HID-PV m 20 /I CDM HPF 220-240V 50/60Hz
EAN/UPC - Product	8711500881632
Order code	913700646266
Numerator - Quantity Per Pack	1
Numerator - Packs per outer box	10
Material Nr. (12NC)	913700646266
Net Weight (Piece)	0.230 kg

Dimensional drawing

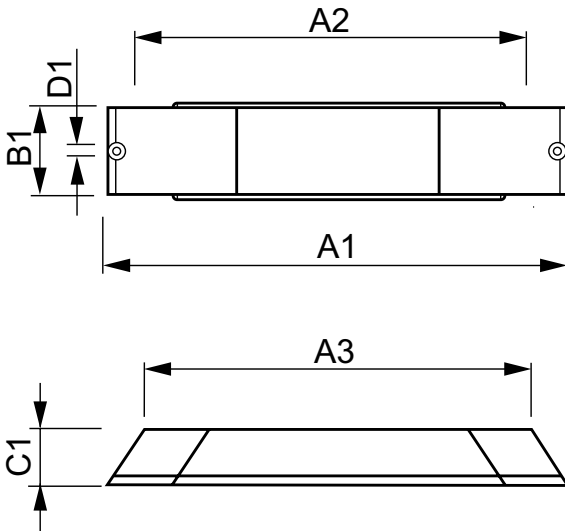

HID-PV m 20 /I CDM HPF 220-240V 50/60Hz

Product	D1	C1	A1	A2	A3	B1
HID-PV m 20 /I CDM HPF 220-240V 50/60Hz	4.8 mm	34.0 mm	234.7 mm	225.1 mm	202.0 mm	49.4 mm

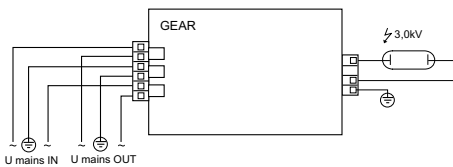

© 2015 Philips Lighting Holding B.V.
All rights reserved.

Specifications are subject to change without notice. Trademarks are the property of Koninklijke Philips N.V. (Royal Philips) or their respective owners.

www.philips.com/lighting

2015, December 23
data subject to change